

CHANDLER PULL – TYPE LITTER AND SHAVING SPREADERS



**Single Axle
or
Tandem Axle**

**(Options listed on
next page)**

**PTO Mechanical
Drive
or
Hydraulic Drive**

**Available with
control, guidance and
variable rate systems
from
Raven Industries**



(Shown with optional hydraulic drive)

**Leading the industry for over 42 – Years as the # 1
manufacturer of Poultry Litter Spreaders**

"Spreader Specifications"

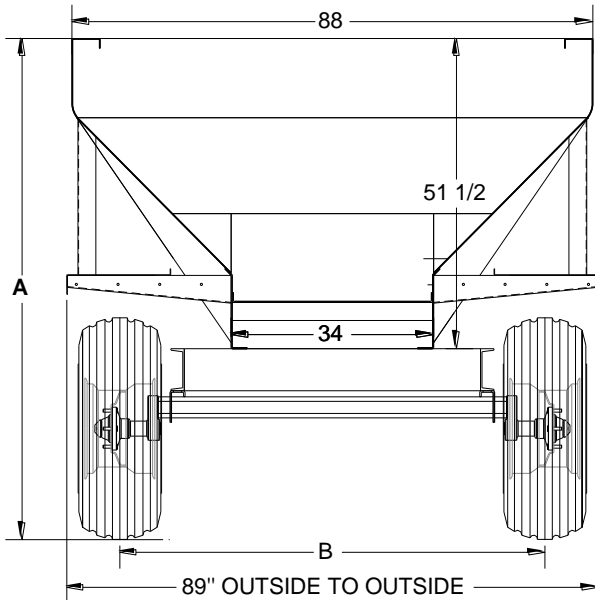

Tire Size	Overall Height "A"	Track "B"
12.5L x 15	82 3/4"	72"
14L x 16.1	85 1/2"	72"
16.5L x 16.1	86 3/4"	78"
19L x 16.1	87 3/4"	79"
21.5L x 16.1	89 3/4"	79"

"Standard Chicken Litter Pull Type Unit"

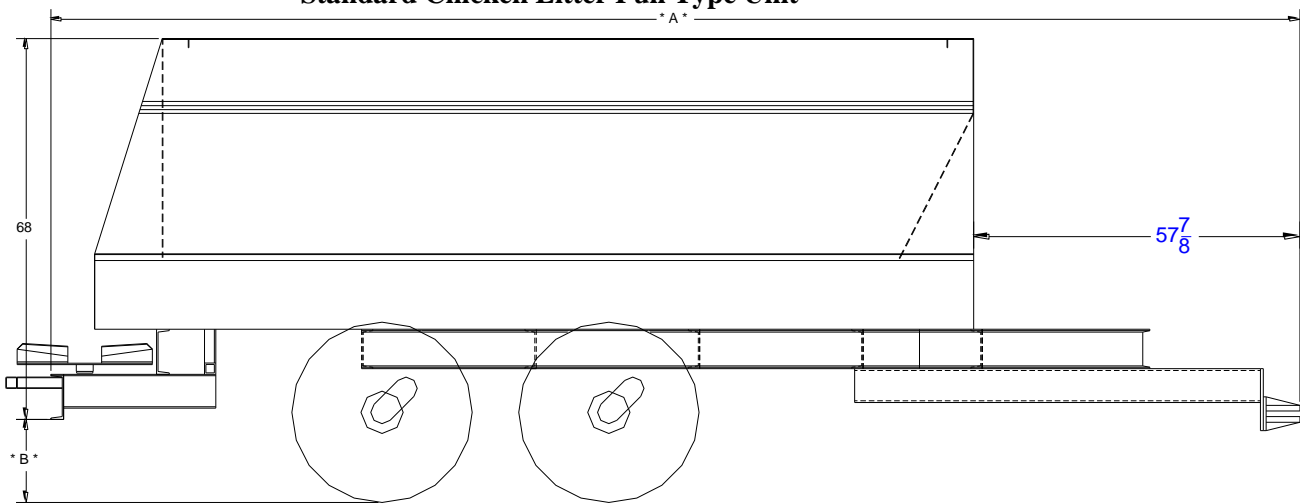

Add 78" to Designated Body Length to get Length "A."

	TIRES			
	12.5L	14L	16.5L	19L
B	14.75"	17.25"	18.75"	19.75"

Add Specified Length Above in Accordance with Tire Size to get Length "B."

Hopper Capacity: (cubic feet struck level)

	<u>12'</u>	<u>14'</u>	<u>16'</u>	<u>18'</u>	<u>20'</u>	<u>22'</u>	<u>24'</u>	<u>26'</u>
45 Degree Slope Sides:	236	275	315	355	394	433	473	512
52 Degree Slope Sides:	213	250	285	320	356	392	427	463

Standard Features

- Hopper Construction: Rails & Floor - 3/16" Plate Sides & Ends - 10 Ga. Mild Steel
- Power Source: 540 PTO with 50:1 worm gear drive with 2" cross shaft (standard)
- Conveyor: 34" wide bar type pintle chain with 3/8" thick bars on 11" centers
- Spinners: Twin 24" disc, 1/4" thick plate with four 9" blades on each
- Tandem axle suspension – (Torsion Axles)
- Lengths from: 10' to 26' available
- 10' – 16' Units – Standard Axles & Tires - 12.5L x 15 Tires – 6500 # rating each
- 18' – 26' Units – Standard Axles and Tires – 16.5L x 16.1 – 10,000 # rating each

Optional Features

Hopper Construction:

- 304 Stainless Steel Hopper
- 304 Stainless Steel Frame Rails & Floor
- 40" Wide Floor (shaving only except when using triple row chain option)
- UHMW Floor Liner
- Inverted "V" (for lime applications - hold weight off conveyor chain)
- Extra Heavy Duty Hopper
- 1/4" Rails and Floor
- 7 Ga. Sides and Ends
- Bolt – On Spinner Assembly
- Extension Brackets and Boards
- 52 Degree Slope Sides

Mechanical Drive (PTO)

- 2 –Speed Gear Case on Conveyor or Spinners (standard speed or shift to 1/3 of standard)
- 1000 RPM PTO Set-Up
- Over-running coupler on spinners (allows spinner to free-wheel)

Hydraulic Options:

- Self Contained Hydraulic System Tandem Pump (mounted on spreader with PTO to tractor)
- Hydraulic Spinners – Plug to Tractor
- Hydraulic Gate – Plug to Tractor
- Electric Switch on Conveyor
- Heavy Duty Spinner Motors

Spinner Options:

- 30" Spinners with 4 - 11", 1/4" Thick Blades (hydraulic model ONLY)
- Heat Treated Spinner blades

Chain Options:

- Heavy Duty Chain – D667xc with 1/2" thick bars
- Triple Row Chain
- Close Spacing on Bars (4 1/2" or 2 1/4")

Axle and Tire Options:

- 14L x 16.1 Tires – 6,500 # axles
- 19L x 16.1 Tires - 10,000 # axles
- 21.5 x 16.1 Tires - 16,000 # axles
- 700/40x22.5 Floatation Tires-16,000# axles

Largest Choice of options of any litter spreader on the market

CHANDLER PULL – TYPE LITTER AND SHAVING SPREADERS



- **Adjustable Flow Divider (for even spread patterns)**
- **Optional: 30” Spinners with 4 – blades each and accurate Spread Patterns out to 50’ (depending on material)**

- **Lengths from 12’ – 26’**
- **Optional:
700/40 –22.5 Flotation
Tires with 16,000 #
Torsion Axles**
- **Optional:
Dual Tandem Motor Gear
Case**

